

MINIMAL
HOLDER
CLEARANCE
(RELIEF)

0.244

0.866 ϕ

1.75 ϕ
HUB

3.030 ϕ

RADIUS
TYP

SECTION A-A

Circular knives are heat treated, to a hardness specified by customer requirements, up to 63 R/C.

Our circular knives are typically made from 52100 steel, but are also available in other tool steels such as D2 and M2. Other materials are also available for quote.

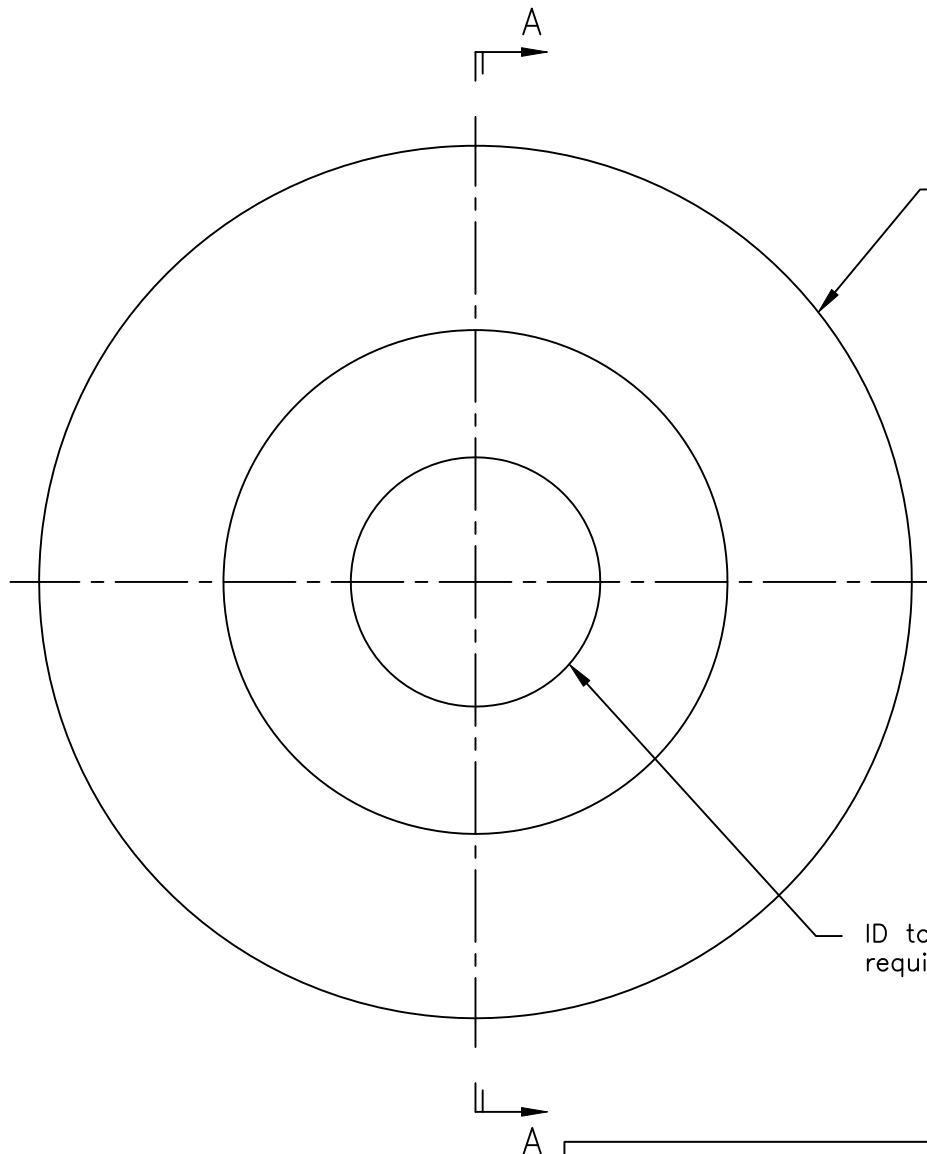

Creaser Blade—
Outer edges have a radius
to prevent blade from
cutting into material.

ID tolerance per customer
requirements.

WEB PRINT

PORTAGE KNIFE
COMPANY

MANUFACTURER OF
SCORE SLITTERS
AND PERFORATORS

A DIVISION OF PORTAGE MACHINE CONCEPTS, INC. AKRON, OHIO (330) 784-0700

300-00-.234

SIZE
A

DWG NAME:
W300-00-234.dwg

SCALE: NONE

DATE: 8/24/2017

DRAWN: D. MILLER

SHEET: 1 OF 1

This print and the intellectual content is the property of Portage Machine Concepts, Inc. and must not be copied, transmitted or disseminated, in any way, without the written permission of Portage Machine Concepts, Inc.